

FERRULE NAILING PLATES

PRODUCT DESCRIPTION

Danterr's **Ferrule Nailing Plates** are engineered for accurate and secure placement of ferrules in precast and tilt-up concrete formwork. These plates screw into ferrules and mechanically fasten to timber formwork, preventing movement during pours while forming a clean recess for post-pour connections. Reusable, durable, and compliant with Australian standards, they enhance speed and precision on construction sites.

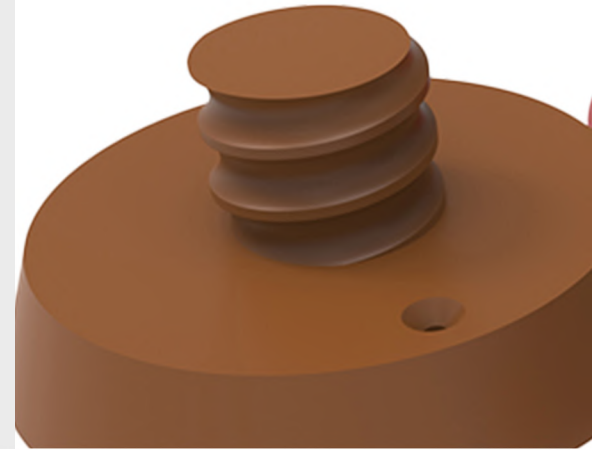

FEATURES & BENEFITS

- Ensures ferrules remain in precise alignment during pours
- Reusable across multiple project cycles
- Supports clean recess formation for post-pour bolt access
- Screw-in + nail-on design suits timber formwork setups
- Color-coded for quick size identification
- Compatible with Danterr's full range of ferrules

AREAS OF APPLICATION

- Precast concrete panels
- Tilt-up panel construction
- Infrastructure and industrial builds
- Accurate ferrule positioning in formwork systems

AVAILABLE SIZES

Product Code	Product Description	Pack Qty
109238	Ferrule Nailing Plate M12	100
111528	Ferrule Nailing Plate M16	100
106590	Ferrule Nailing Plate M20	100
111529	Ferrule Nailing Plate M24	100

TECHNICAL DATA SHEET

Property	Unit	Value/Notes
Compatible Ferrule Sizes	mm	M12, M16, M20, M24
Material	-	High-strength, reusable plastic
Installation Method	-	Screw into ferrule, nail to formwork
Reusability	-	Yes – suitable for multiple uses
Identification	-	Color-coded for size differentiation
Compliance	-	Meets AU/NZ construction standards

