

Connolly Expansion Joints

PRODUCT DESCRIPTION

Connolly Expansion Joints provide a continuous pour solution for managing slab-on-ground concrete movement. The roll-formed galvanized steel profile is bonded to 10mm closed-cell, cross-linked polyethylene foam to create a leave-in-place formwork that allows for controlled joint expansion while maintaining structural integrity.

Supplied in 3.0m lengths for slab thicknesses ranging from 100mm to 200mm, the system incorporates Connolly's patented peg and wedge fixing system and dowelling system for superior load transfer, straighter joints, and fast installation.



FEATURES & BENEFITS

- Enables continuous pours for improved site efficiency
- Provides up to 10mm expansion capacity over full slab depth
- Straight steel profile ensures cleaner, straighter joints
- Includes dowels and sleeves for optimal load transfer
- Patented peg and wedge fixing system for easy, accurate height adjustment
- Galvanized steel for long-term corrosion protection
- Can be screeded directly for accurate leveling
- Supplied complete with all fixings and dowel components
- Complies with AU/NZ construction standards

AREAS OF APPLICATION

- Footpaths and pedestrian walkways
- Industrial slab-on-ground construction
- Continuous pour concrete slabs
- Warehouse and commercial flooring
- Public infrastructure pavements

AVAILABLE SIZES

Product Code	Description	Inclusions
106621	Expansion Joint System 100mm x 3.0m	1 x Key Joint 100mm x 3.0m 9 x Dowel Bars 12mm x 300mm Galvanized 9 x Dowel Sleeves 12mm x 150mm Green 1 x Pegs & Wedges Pack (4 pcs)
104962	Expansion Joint System 125mm x 3.0m	1 x Key Joint 125mm x 3.0m 7 x Dowel Bars 16mm x 450mm Galvanized 7 x Dowel Sleeves 16mm x 225mm Purple 1 x Pegs & Wedges Pack (4 pcs)
101804	Expansion Joint System 150mm x 3.0m	1 x Key Joint 150mm x 3.0m 7 x Dowel Bars 16mm x 450mm Galvanized 7 x Dowel Sleeves 16mm x 225mm Purple 1 x Pegs & Wedges Pack (4 pcs)
106622	Expansion Joint System 200mm x 3.0m	1 x Key Joint 200mm x 3.0m 7 x Dowel Bars 24mm x 450mm Galvanized 7 x Dowel Sleeves 24mm x 225mm Orange 1 x Pegs & Wedges Pack (4 pcs)

Connolly Expansion Joints

TECHNICAL SPECIFICATIONS

Material Specifications

Component	Specification	Standard
Steel Profile	Galvanized Steel 200g/m ²	AS/NZS 3679.1:2010
Galvanizing	Hot-Dip Galvanized	AS/NZS 4680:2006
Foam	10mm Closed-Cell, Cross-Linked PE Foam	Internal Standard
Expansion Capacity	Up to 10mm	Internal
Profile Length	3.0m	Internal

Dowel Specifications

Dowel Diameter	Dowel Length	Finish
12mm	300mm	Hot-Dip Galvanized
16mm	450mm	Hot-Dip Galvanized
24mm	450mm	Hot-Dip Galvanized

Connolly Expansion Joints

INSTALLATION GUIDE

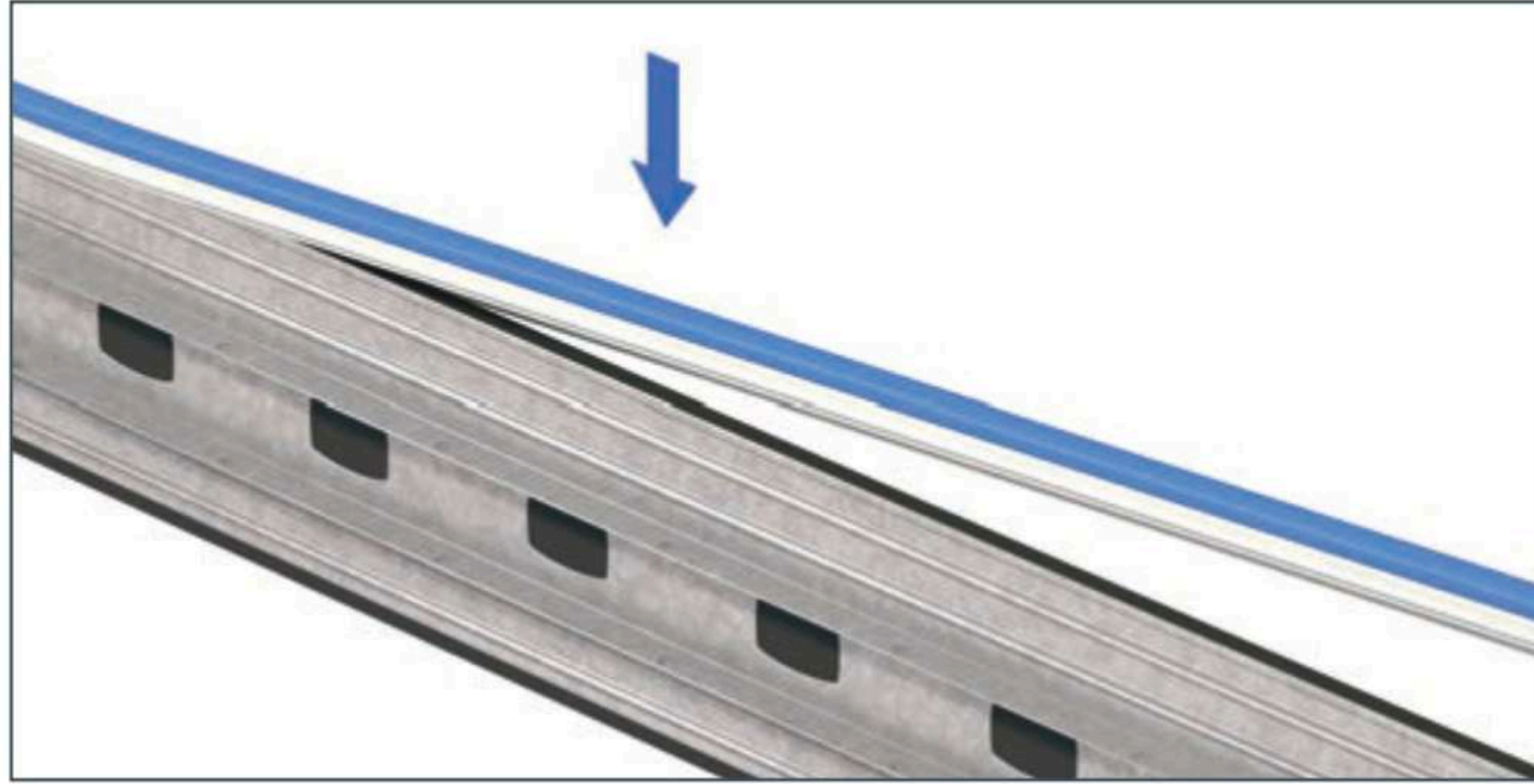

Step 1

In the case where permanent capping or a rebate mould is used, ensure it is pushed firmly onto the top of the system prior to placement.

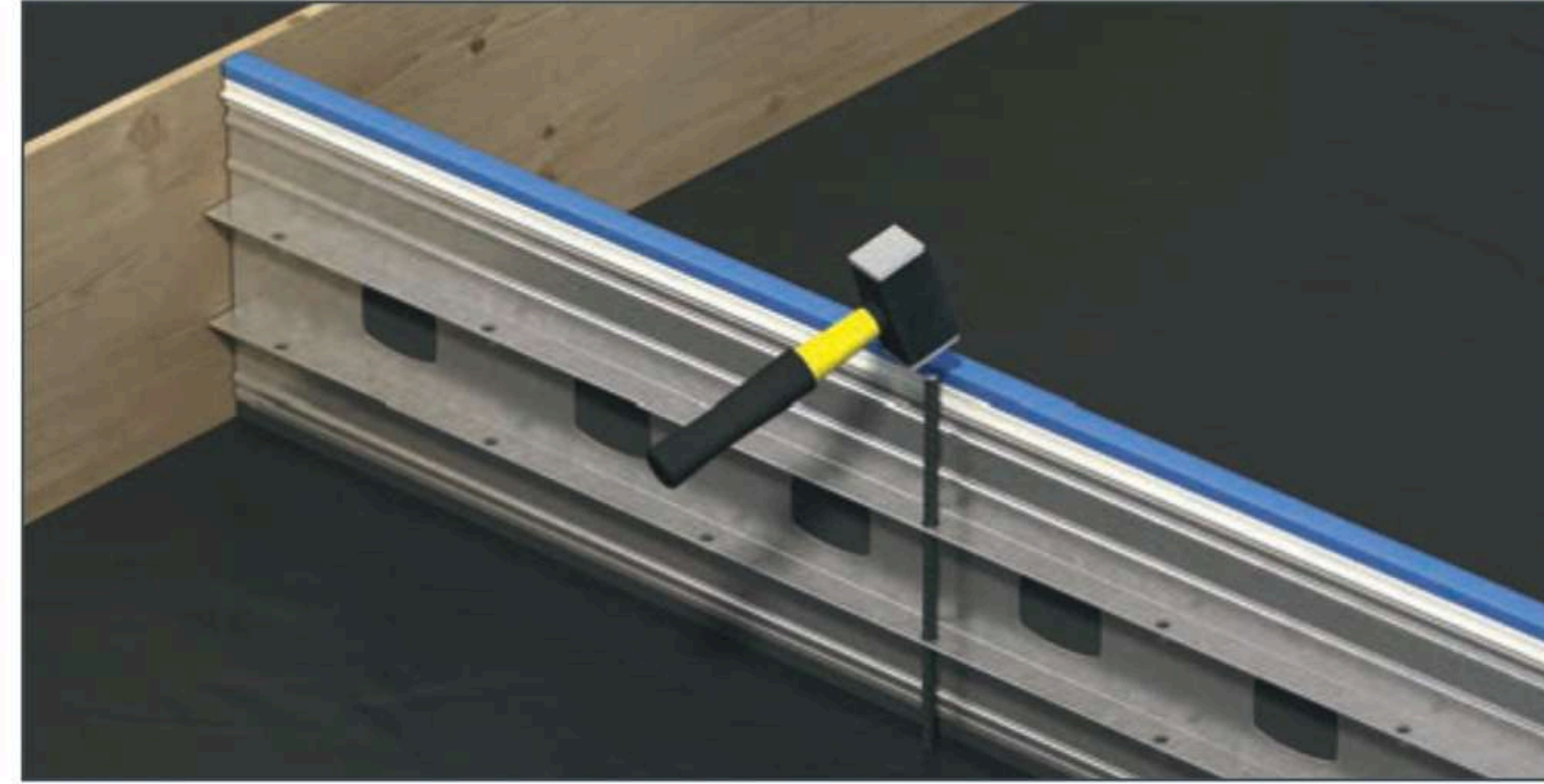

Step 2

Position the expansion joint profile in the desired location and drive in the supplied pegs. Ensure the top of the peg is at least 20mm below the intended level of the finished concrete.

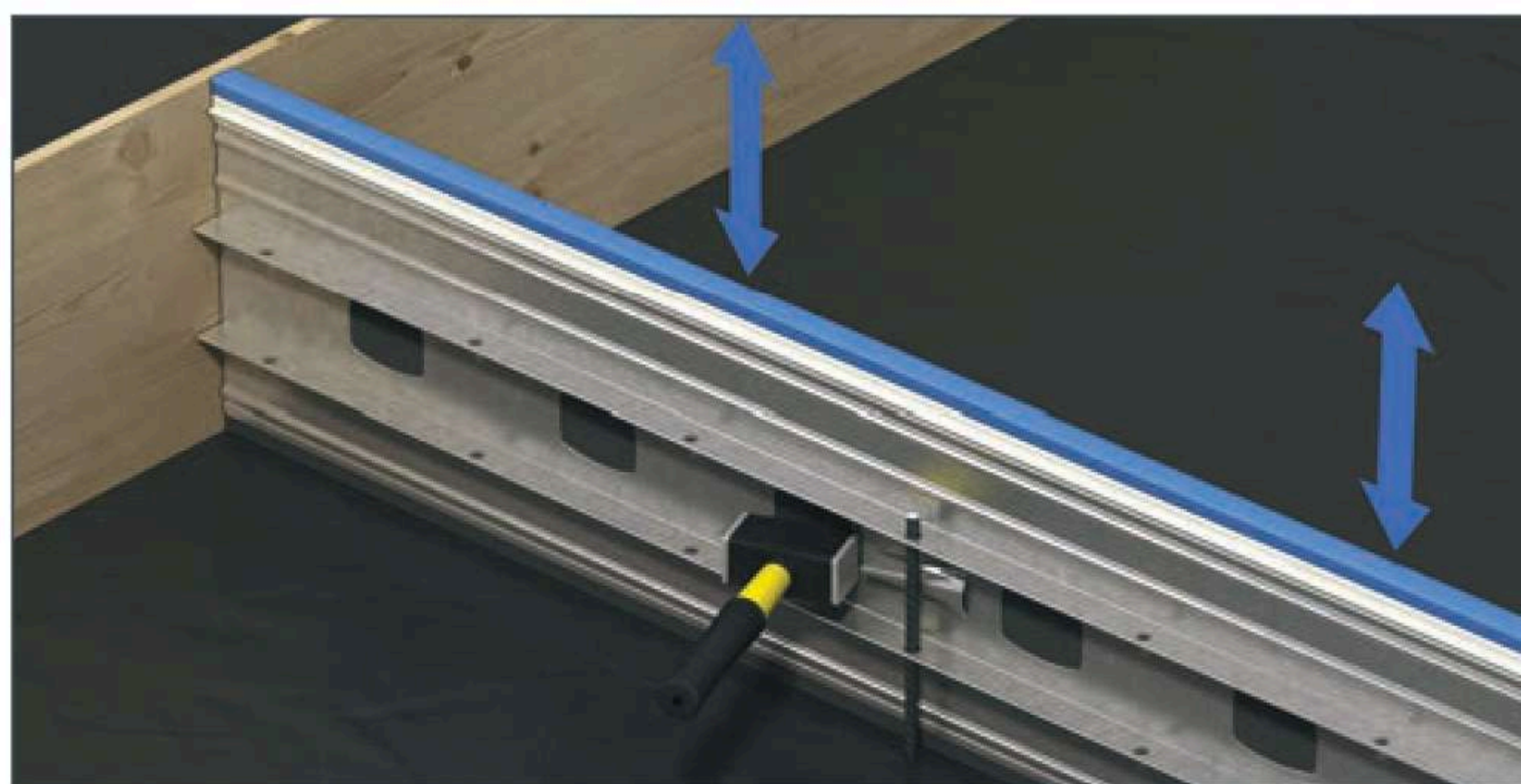

Step 3

Adjust the profile to the correct height and secure by tapping in the supplied wedges.

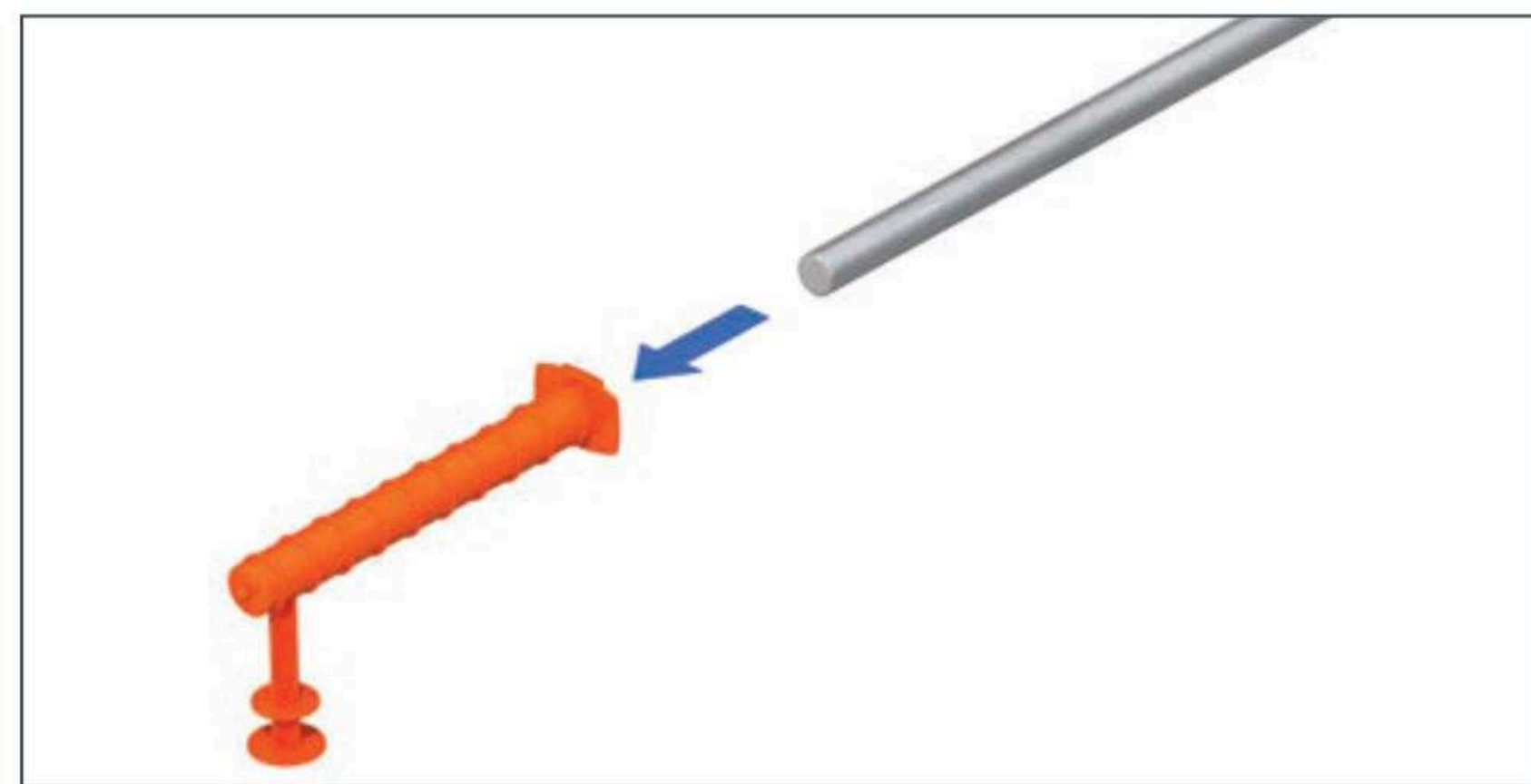

Step 4

Insert dowels into the Universal Dowel Sleeves by pressing all the way to the end of the sleeve.

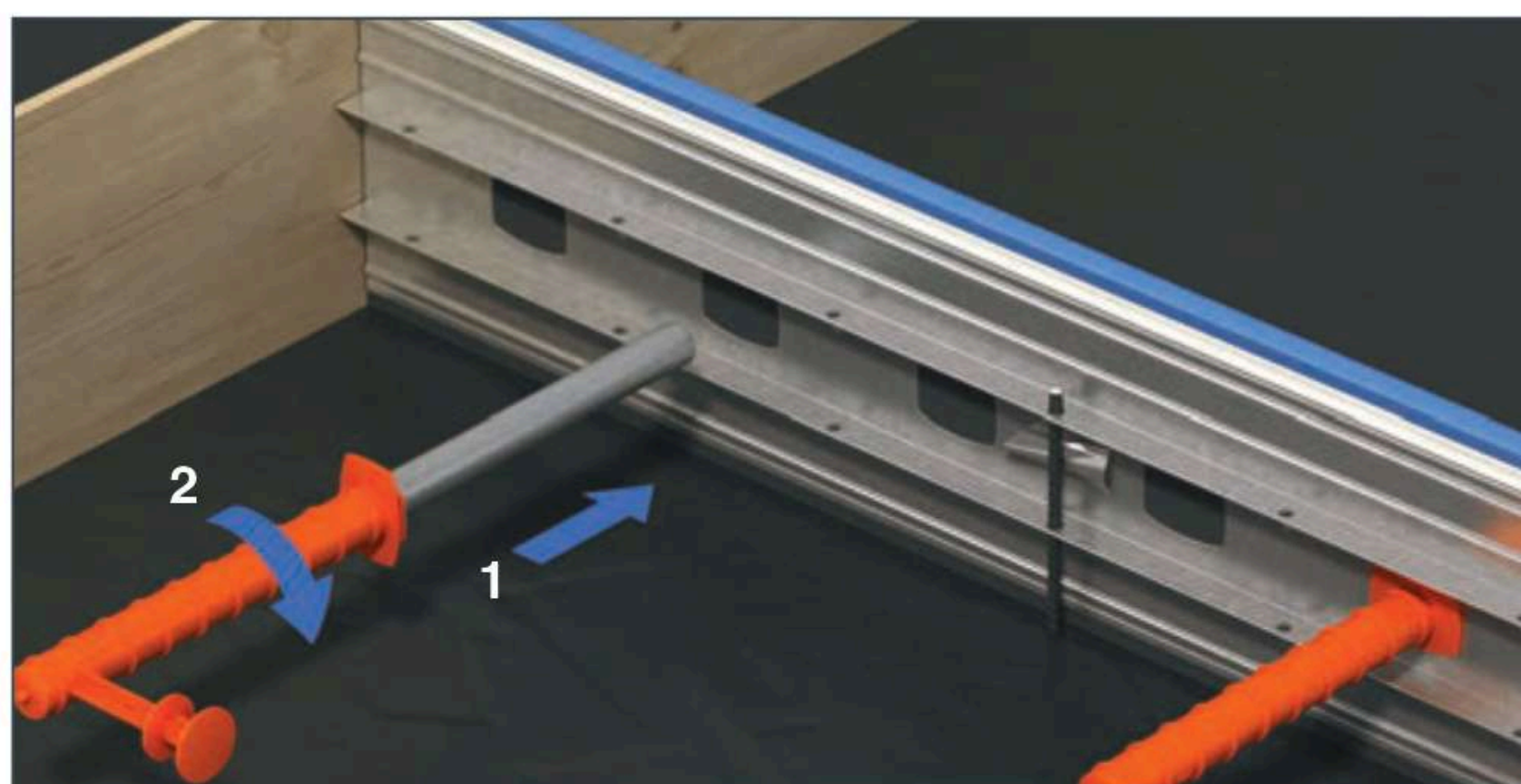

Step 5

Install the Universal Dowel Sleeve in the profile by pushing the dowel through the foam at the centre of the pre-punched holes and twist the sleeve 90 degrees to fix in place.



Step 6

Place reinforcement and pour concrete evenly to both sides of the expansion joint at the same time. Finish surface and ensure top of joint is clear of any concrete.

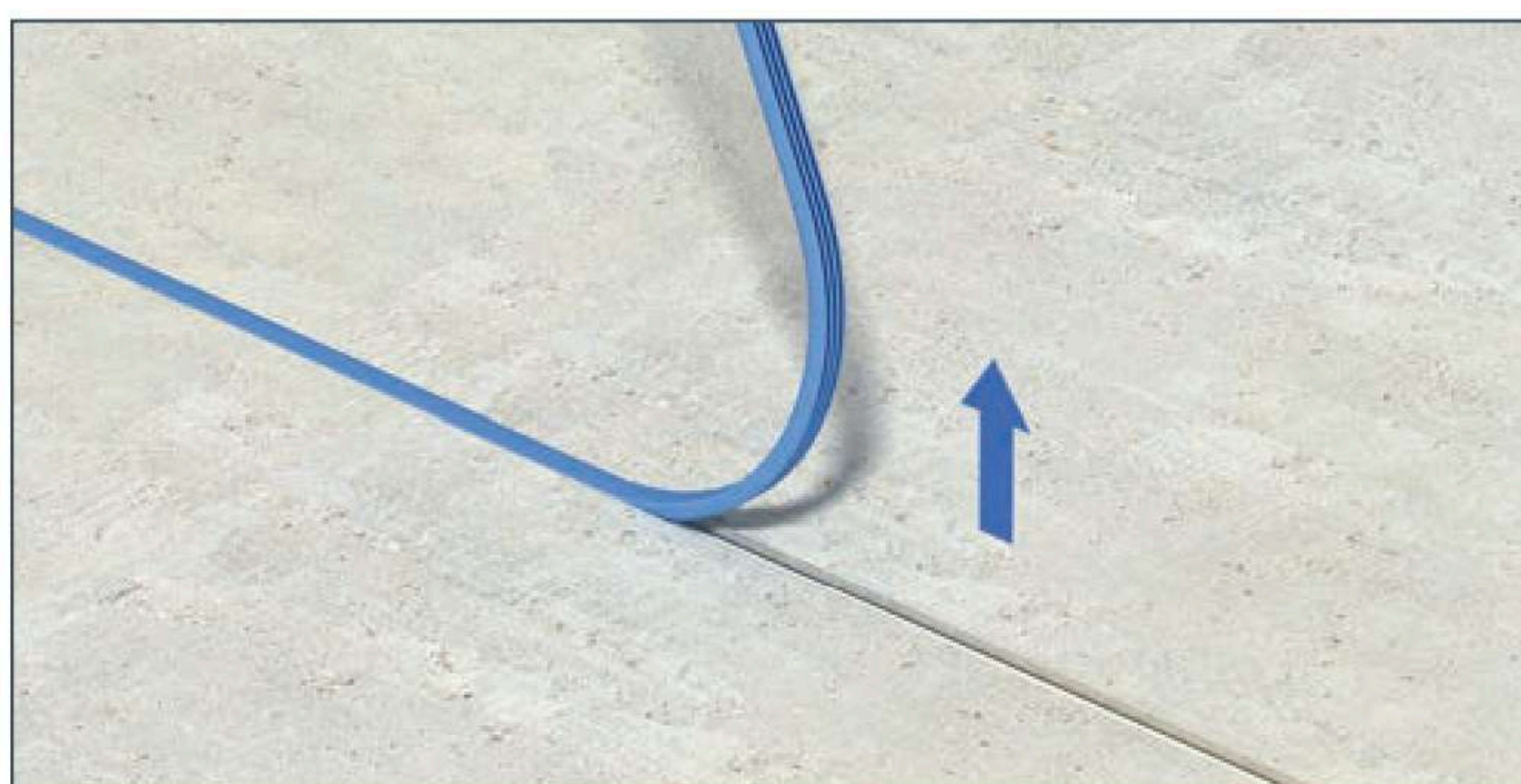

Step 7

Pull out the top profile and apply sealant to manufacturer's specifications.
Note: This step is only applicable when a rebate mould is used.

